

# Class 600-2500 Steel End Flange Dimensions

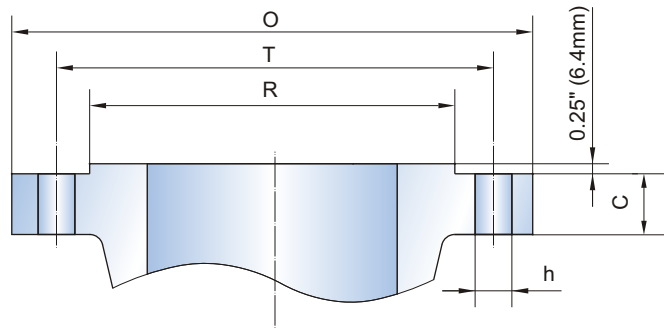

## CLASS 600-2500 RF



CLASS	SIZE		O		R		C		T		h		Bolt	
	in	mm	in	mm	in	mm	in	mm	in	mm	in	mm	QTY.	Diameter
600	2	50	6.50	165	3.62	92	1.00	26	5.00	127	0.75	19	8	5/8
	2 1/2	65	7.50	190	4.12	105	1.12	29	5.88	149	0.88	22	8	3/4
	3	80	8.25	210	5.00	127	1.25	32	6.62	168	0.88	22	8	3/4
	4	100	10.75	273	6.19	157	1.50	38	8.50	216	1.00	25	8	7/8
	6	150	14.00	356	8.50	216	1.88	48	11.50	292	1.12	29	12	1
	8	200	16.50	419	10.62	270	2.19	56	13.75	349	1.25	32	12	1 1/8
	10	250	20.00	508	12.75	324	2.50	64	17.00	432	1.38	35	16	1 1/4
	12	300	22.00	559	15.00	381	2.62	67	19.25	489	1.38	35	20	1 1/4
	14	350	23.75	603	16.25	413	2.75	70	20.75	527	1.50	38	20	1 3/8
	16	400	27.00	686	18.50	470	3.00	77	23.75	603	1.62	41	20	1 1/2
	18	450	29.25	743	21.00	533	3.25	83	25.75	654	1.75	44	20	1 5/8
20	500	32.00	813	23.00	584	3.50	89	28.50	724	1.75	44	24	1 5/8	
24	600	37.00	940	27.25	692	4.00	102	33.00	838	2.00	51	24	1 7/8	
900	2	50	8.50	216	3.62	92	1.50	38.5	6.50	165.1	1.00	26	8	7/8
	2 1/2	65	9.62	244	4.12	105	1.62	41.5	7.50	190.5	1.12	29	8	1
	3	80	9.50	241	5.00	127	1.50	38.5	7.50	190.5	1.00	26	8	7/8
	4	100	11.50	292	6.19	157	1.75	44.5	9.25	234.9	1.25	32	8	1 1/8
	6	150	15.00	381	8.50	216	2.19	56.0	12.50	317.5	1.25	32	12	1 1/8
	8	200	18.50	470	10.62	270	2.50	63.5	15.50	393.7	1.50	39	12	1 3/8
	10	250	21.50	545	12.75	324	2.75	70.0	18.50	469.9	1.50	39	16	1 3/8
	12	300	24.00	610	15.00	381	3.12	79.5	21.00	533.4	1.50	39	20	1 3/8
	14	350	25.25	640	16.25	413	3.38	86.0	22.00	558.8	1.62	42	20	1 1/2
	16	400	27.75	705	18.50	470	3.50	89.0	24.25	615.9	1.75	45	20	1 5/8
	18	450	31.00	785	21.00	533	4.00	102.0	27.00	685.8	2.00	51	20	1 7/8
20	500	33.75	855	23.00	584	4.25	108.0	29.50	749.3	2.12	54	20	2	
24	600	41.00	1040	27.25	692	5.50	140.0	35.50	901.7	2.62	67	20	2 1/2	
1500	2	50	8.50	216	3.62	92	1.50	38.5	6.50	165.1	1.00	26	8	1
	2 1/2	65	9.62	244	4.12	105	1.62	41.5	7.50	190.5	1.12	29	8	1 1/8
	3	80	10.50	267	5.00	127	1.88	48.0	8.00	203.2	1.25	32	8	1 1/4
	4	100	12.25	311	6.19	157	2.12	54.0	9.50	241.3	1.38	35	8	1 3/8
	6	150	15.50	394	8.50	216	3.25	83.0	12.50	317.5	1.50	39	12	1 1/2
	8	200	19.00	483	10.62	270	3.62	92.9	15.50	393.7	1.75	45	12	1 3/4
	10	250	23.00	585	12.75	324	4.25	108.0	19.00	482.6	2.00	51	12	2
	12	300	26.50	675	15.00	381	4.88	124.0	22.50	571.5	2.12	54	16	2 1/8
	14	350	29.50	750	16.25	413	5.25	133.5	25.00	635.0	2.38	61	16	2 3/8
	16	400	32.50	825	18.50	470	5.75	146.5	27.75	704.8	2.62	67	16	2 5/8
	18	450	36.00	915	21.00	533	6.38	162.0	30.50	774.7	2.88	74	16	2 7/8
20	500	38.75	985	23.00	584	7.00	178.0	32.75	831.8	3.12	80	16	3 1/8	
24	600	46.00	1170	27.25	692	8.00	203.5	39.00	990.6	3.62	93	16	3 5/8	
2500	2	50	9.25	235	3.62	92	2.00	51.0	6.75	171.4	1.12	29	8	1
	2 1/2	65	10.50	267	4.12	105	2.25	57.5	7.75	196.8	1.25	32	8	1 1/8
	3	80	12.00	305	5.00	127	2.62	67.0	9.00	228.6	1.38	35	8	1 1/4
	4	100	14.00	356	6.19	157	3.00	76.5	10.75	273.0	1.62	42	8	1 1/2
	6	150	19.00	483	8.50	216	4.25	108.0	14.50	368.3	2.12	54	8	2
	8	200	21.75	550	10.62	270	5.00	127.0	17.25	438.1	2.12	54	12	2
	10	250	26.50	675	12.75	324	6.50	165.5	21.25	539.7	2.62	67	12	2 1/2
12	300	30.00	760	15.00	381	7.25	184.5	24.38	619.1	2.88	74	12	2 3/4	

End Flange Dimensions: ASME B16.5  
Tolerances: the Same as Class 150 300